

SCHI Series



Features

Very large rated current and low direct-current resistance
 No cross coupling between inductors due to low magnetic shield and high reliability.
 No lead, ideal for high density SMT installation, with no directionality.

Applications

DC-DC converters
 Power modules
 Cellular phones
 DSC, PND, DVD
 Wireless card and other electronic devices

General Specifications

Test frequency..... 1MHz
 Test Voltage.....50mV
 Parameters Test Temp..... 25℃
 Operation Temp.....-55℃ to +125℃
 (Including temperature Rise)
 Storage Temp.....0~40℃
 Storage Humidity.....<70% RH
 Resistance to Soldering Heat.....260℃ for 10 sec
 Rated Current.....40℃ typ. at Irms

Product Identification

SCHIXXXXXTL - XXX
 For example: SCHI201209TL-1R0

Shape And Dimensions

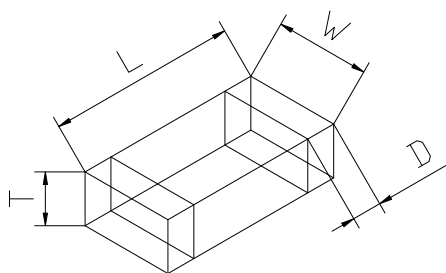

PAD Layout

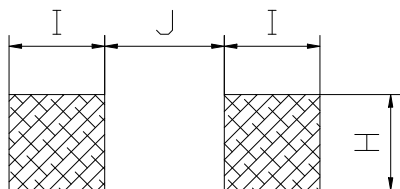

Dimensions In mm

TYPE	L	W	T	D	H	I	J
					Ref	Ref	Ref
201209 (0805)	2.00±0.20 (0.079±0.008)	1.20±0.20 (0.047±0.008)	0.90±0.20 (0.035±0.008)	0.50±0.30 (0.020±0.012)	1.00 (0.040)	1.40 (0.055)	1.20 (0.047)
252009 (1008)	2.50±0.20 (0.098±0.008)	2.00±0.20 (0.079±0.008)	0.90±0.20 (0.035±0.008)	0.50±0.30 (0.020±0.012)	2.00 (0.079)	0.80 (0.031)	1.80 (0.071)
321609 (1206)	3.20±0.20 (0.126±0.008)	1.60±0.20 (0.063±0.008)	0.90±0.20 (0.035±0.008)	0.50±0.30 (0.020±0.012)	1.20 (0.047)	2.25 (0.089)	2.00 (0.079)

Standard Specifications

Stamp	Inductance (uH)	Test frequency (MHz)	Test voltage (mV)	DCR (Ω) Max	SRF (MHz) Min	Rated current (mA) Max
SCH1201209TL-47N	0.047	1	50	0.10	280	1100
SCH1201209TL-56N	0.056	1	50	0.10	280	1100
SCH1201209TL-68N	0.068	1	50	0.15	250	1100
SCH1201209TL-82N	0.082	1	50	0.15	250	1100
SCH1201209TL-R10	0.10	1	50	0.15	210	1100
SCH1201209TL-R12	0.12	1	50	0.15	200	1100
SCH1201209TL-R15	0.15	1	50	0.15	175	1100
SCH1201209TL-R18	0.18	1	50	0.15	160	1100
SCH1201209TL-R22	0.22	1	50	0.15	150	1100
SCH1201209TL-R27	0.27	1	50	0.15	130	1100
SCH1201209TL-R33	0.33	1	50	0.15	120	1100
SCH1201209TL-R39	0.39	1	50	0.15	110	1100
SCH1201209TL-R47	0.47	1	50	0.15	100	1100
SCH1201209TL-R56	0.56	1	50	0.20	100	800
SCH1201209TL-R68	0.68	1	50	0.20	95	800
SCH1201209TL-R82	0.82	1	50	0.20	90	800
SCH1201209TL-1R0	1.00	1	50	0.24	75	800
SCH1201209TL-1R2	1.20	1	50	0.24	65	800
SCH1201209TL-1R5	1.50	1	50	0.30	60	700
SCH1201209TL-1R8	1.80	1	50	0.36	55	600
SCH1201209TL-2R2	2.20	1	50	0.36	50	600
SCH1201209TL-2R7	2.70	1	50	0.36	45	600
SCH1201209TL-3R3	3.30	1	50	0.40	41	350
SCH1201209TL-3R9	3.90	1	50	0.40	38	350
SCH1201209TL-4R7	4.70	1	50	0.40	35	350
SCH1201209TL-5R6	5.60	1	50	0.50	32	250
SCH1201209TL-6R8	6.80	1	50	0.50	29	250
SCH1201209TL-8R2	8.20	1	50	0.56	26	250
SCH1201209TL-100	10.0	1	50	0.56	24	250
SCH1201209TL-120	12.0	1	50	0.56	22	250
SCH1201209TL-150	15.0	1	50	0.65	19	100
SCH1201209TL-180	18.0	1	50	0.65	18	100
SCH1201209TL-220	22.0	1	50	0.65	16	100

Note: When ordering, please specify tolerance code. Tolerance: K=±10%, M=±20%, N=±30%

*All the data listed in this catalogue are for reference only, JENG SHI reserves the right to alter or revise the specifications without prior notification.

*Beyond the above specification also can meet the special requirements. Need detailed content Please to the website query or contact us.

Standard Specifications

Stamp	Inductance (uH)	Test frequency (MHz)	Test voltage (mV)	DCR (Ω) Max	SRF (MHz) Min	Rated current (mA) Max
SCH1252009TL-1R0	1.00	1	50	0.12	70	1500
SCH1252009TL-1R2	1.20	1	50	0.15	50	1500
SCH1252009TL-1R5	1.50	1	50	0.15	50	1500
SCH1252009TL-1R8	1.80	1	50	0.18	40	1000
SCH1252009TL-2R2	2.20	1	50	0.18	40	1000
SCH1252009TL-2R7	2.70	1	50	0.22	30	1000
SCH1252009TL-3R3	3.30	1	50	0.22	30	1000
SCH1252009TL-3R9	3.90	1	50	0.26	25	1000
SCH1252009TL-4R7	4.70	1	50	0.26	25	1000

Note: When ordering, please specify tolerance code. Tolerance: K=±10%, M=±20%, N=±30%

*All the data listed in this catalogue are for reference only, JENG SHI reserves the right to alter or revise the specifications without prior notification.

*Beyond the above specification also can meet the special requirements. Need detailed content Please to the website query or contact us.

Standard Specifications

Stamp	Inductance (uH)	Test frequency (MHz)	Test voltage (mV)	DCR (Ω) Max	SRF (MHz) Min	Rated current (mA) Max
SCHI321609TL-47N	0.047	1	50	0.01	250	1800
SCHI321609TL-56N	0.056	1	50	0.01	250	1800
SCHI321609TL-68N	0.068	1	50	0.06	230	1800
SCHI321609TL-82N	0.082	1	50	0.06	230	1800
SCHI321609TL-R10	0.10	1	50	0.06	215	1500
SCHI321609TL-R12	0.12	1	50	0.06	190	1500
SCHI321609TL-R15	0.15	1	50	0.06	165	1500
SCHI321609TL-R18	0.18	1	50	0.06	150	1500
SCHI321609TL-R22	0.22	1	50	0.06	130	1500
SCHI321609TL-R27	0.27	1	50	0.06	110	1500
SCHI321609TL-R33	0.33	1	50	0.06	100	1500
SCHI321609TL-R39	0.39	1	50	0.90	90	1400
SCHI321609TL-R47	0.47	1	50	0.90	80	1400
SCHI321609TL-R56	0.56	1	50	0.10	75	1100
SCHI321609TL-R68	0.68	1	50	0.10	65	1100
SCHI321609TL-R82	0.82	1	50	0.10	60	1100
SCHI321609TL-1R0	1.00	1	50	0.15	60	1200
SCHI321609TL-1R2	1.20	1	50	0.15	65	1200
SCHI321609TL-1R5	1.50	1	50	0.17	60	1000
SCHI321609TL-1R8	1.80	1	50	0.24	55	900
SCHI321609TL-2R2	2.20	1	50	0.24	50	900
SCHI321609TL-2R7	2.70	1	50	0.30	45	800
SCHI321609TL-3R3	3.30	1	50	0.30	41	800
SCHI321609TL-3R9	3.90	1	50	0.38	38	700
SCHI321609TL-4R7	4.70	1	50	0.38	35	700
SCHI321609TL-5R6	5.60	1	50	0.45	32	500
SCHI321609TL-6R8	6.80	1	50	0.45	29	500
SCHI321609TL-8R2	8.20	1	50	0.55	26	300
SCHI321609TL-100	10.0	1	50	0.55	24	300
SCHI321609TL-120	12.0	1	50	0.55	22	300
SCHI321609TL-150	15.0	1	50	0.65	19	100
SCHI321609TL-180	18.0	1	50	0.65	18	100
SCHI321609TL-220	22.0	1	50	0.85	16	100
SCHI321609TL-270	27.0	1	50	0.85	14	100

Note: When ordering, please specify tolerance code. Tolerance: K=±10%, M=±20%, N=±30%

*All the data listed in this catalogue are for reference only, JENG SHI reserves the right to alter or revise the specifications without prior notification.

*Beyond the above specification also can meet the special requirements. Need detailed content Please to the website query or contact us.