

## SCCI Series

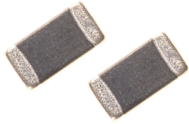

### Features

RoHS compliant  
High mounting density of compact circuit due to crosstalk elimination that results from a closed magnetic flux in a ferrite material  
Suitable for flow and re-flow solering  
Available in 5 sizes

### Applications

Personal computers, HDDs, other various electronic Devices  
Any portable device where compact size and high mounting densities are required.

### Product Identification

SCCIXXXXXTL - XXXX  
For example:SCCI100505TL-1R0K

### General Specifications

Test frequency.....1~ 50MHz  
Test Voltage.....50mV  
Parameters Test Temp..... 25℃  
Operation Temp.....-55℃ to +125℃  
(Including temperature Rise)  
Storage Temp.....0~40℃  
Storage Humidity.....<70% RH  
Resistance to Soldering Heat.....260℃ for 10 sec  
Rated Current.....40℃ typ. at Irms

## Shape And Dimensions

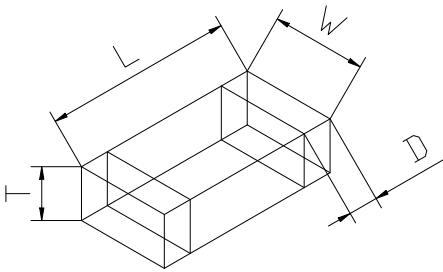

## PAD Layout

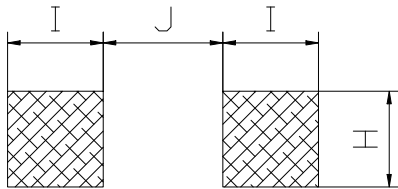

## Dimensions In mm

TYPE	L	W	T	D	H	I	J
					Ref	Ref	Ref
100505 (0402)	1.00±0.15 (0.040±0.006)	0.50±0.15 (0.020±0.006)	0.50±0.15 (0.020±0.006)	0.25±0.10 (0.010±0.004)	0.40 (0.016)	0.50 (0.020)	0.40 (0.016)
160808 (0603)	1.60±0.20 (0.063±0.008)	0.80±0.20 (0.031±0.008)	0.80±0.20 (0.031±0.008)	0.30±0.20 (0.010±0.008)	0.60 (0.024)	1.30 (0.051)	0.80 (0.031)
201209 (0805)	2.00±0.20 (0.079±0.008)	1.20±0.20 (0.047±0.008)	0.90±0.20 (0.035±0.008)	0.50±0.30 (0.020±0.012)	1.00 (0.040)	1.40 (0.055)	1.20 (0.047)
321609 (1206)	3.20±0.20 (0.126±0.008)	1.60±0.20 (0.063±0.008)	0.90±0.20 (0.035±0.008)	0.50±0.30 (0.020±0.012)	1.20 (0.047)	2.25 (0.089)	2.00 (0.079)
322513 (1210)	3.20±0.20 (0.126±0.008)	2.50±0.20 (0.098±0.008)	1.30±0.20 (0.051±0.008)	0.50±0.30 (0.020±0.012)	1.80 (0.071)	2.25 (0.089)	2.00 (0.079)
453215 (1812)	4.50±0.20 (0.180±0.008)	3.20±0.20 (0.126±0.008)	1.50±0.20 (0.060±0.008)	0.50±0.30 (0.020±0.012)	2.40 (0.095)	1.75 (0.069)	3.00 (0.118)

## Standard Specifications

Stamp	Inductance (uH)	Tolerance	Q (Min)	DCR (Ω) Max	Test frequency (MHz)	Test voltage (mV)	SRF (MHz) Min	Rated current (mA) Max
SCCI100505TL-47N	0.047	±10%	10	0.45	50	50	220	25
SCCI100505TL-56N	0.056	±10%	10	0.45	50	50	210	25
SCCI100505TL-68N	0.068	±10%	10	0.45	50	50	210	25
SCCI100505TL-82N	0.082	±10%	10	0.45	50	50	200	25
SCCI100505TL-R10	0.10	±10%	15	0.70	25	50	200	25
SCCI100505TL-R12	0.12	±10%	15	0.70	25	50	165	25
SCCI100505TL-R15	0.15	±10%	15	0.80	25	50	140	25
SCCI100505TL-R18	0.18	±10%	15	0.80	25	50	120	25
SCCI100505TL-R22	0.22	±10%	15	1.00	25	50	110	25
SCCI100505TL-R27	0.27	±10%	15	1.20	25	50	95	25
SCCI100505TLR33	0.33	±10%	15	1.20	25	50	85	25
SCCI100505TL-R39	0.39	±10%	15	1.30	10	50	70	20
SCCI100505TL-R47	0.47	±10%	15	1.50	10	50	68	20
SCCI100505TL-R56	0.56	±10%	15	2.00	10	50	55	20
SCCI100505TL-R68	0.68	±10%	15	2.30	10	50	50	20
SCCI100505TL-R82	0.82	±10%	15	3.00	10	50	45	18
SCCI100505TL-1R0	1.00	±10%	20	0.90	10	50	40	25
SCCI100505TL-1R2	1.20	±10%	20	1.20	10	50	35	25

Note: When ordering, please specify tolerance code. Tolerance: K=±10%, M=±20%

\*All the data listed in this catalogue are for reference only, JENG SHI reserves the right to alter or revise the specifications without prior notification.

\*Beyond the above specification also can meet the special requirements. Need detailed content Please to the website query or contact us.

## Standard Specifications

Stamp	Inductance (uH)	Tolerance	Q (Min)	DCR (Ω) Max	Test frequency (MHz)	Test voltage (mV)	SRF (MHz) Min	Rated current (mA) Max
SCCI160808TL-47N	0.047	±10%	15	0.20	50	50	260	50
SCCI160808TL-56N	0.056	±10%	15	0.20	50	50	260	50
SCCI160808TL-68N	0.068	±10%	15	0.20	50	50	250	50
SCCI160808TL-82N	0.082	±10%	15	0.20	50	50	245	50
SCCI160808TL-R10	0.10	±10%	20	0.25	25	50	240	50
SCCI160808TL-R12	0.12	±10%	20	0.30	25	50	205	50
SCCI160808TL-R15	0.15	±10%	20	0.30	25	50	180	50
SCCI160808TL-R18	0.18	±10%	20	0.30	25	50	165	50
SCCI160808TL-R22	0.22	±10%	20	0.40	25	50	150	50
SCCI160808TL-R27	0.27	±10%	20	0.45	25	50	136	50
SCCI160808TL-R33	0.33	±10%	20	0.50	25	50	125	50
SCCI160808TL-R39	0.39	±10%	20	0.60	25	50	110	50
SCCI160808TL-R47	0.47	±10%	20	0.70	25	50	105	50
SCCI160808TL-R56	0.56	±10%	20	0.70	25	50	95	50
SCCI160808TL-R68	0.68	±10%	20	0.90	25	50	90	50
SCCI160808TL-R82	0.82	±10%	20	1.00	25	50	85	50
SCCI160808TL-1R0	1.00	±10%	25	0.50	10	50	75	25
SCCI160808TL-1R2	1.20	±10%	25	0.55	10	50	65	25
SCCI160808TL-1R5	1.50	±10%	25	0.70	10	50	60	25
SCCI160808TL-1R8	1.80	±10%	25	0.75	10	50	55	25
SCCI160808TL-2R2	2.20	±10%	25	0.80	10	50	50	25
SCCI160808TL-2R7	2.70	±10%	25	0.90	10	50	45	15
SCCI160808TL-3R3	3.30	±10%	25	1.00	10	50	40	15
SCCI160808TL-3R9	3.90	±10%	25	1.30	10	50	35	15
SCCI160808TL-4R7	4.70	±10%	25	1.50	10	50	33	15
SCCI160808TL-5R6	5.60	±10%	12	1.55	4	50	22	5
SCCI160808TL-6R8	6.80	±10%	12	1.55	4	50	20	5
SCCI160808TL-8R2	8.20	±10%	12	1.65	4	50	18	5
SCCI160808TL-100	10.00	±10%	20	1.75	2	50	17	3
SCCI160808TL-120	12.00	±10%	20	1.85	2	50	15	3
SCCI160808TL-150	15.00	±10%	20	2.50	1	50	14	1
SCCI160808TL-180	18.00	±10%	20	2.70	1	50	13	1
SCCI160808TL-220	22.00	±10%	20	3.00	1	50	12	1

Note: When ordering, please specify tolerance code. Tolerance: K=±10%, M=±20%

\*All the data listed in this catalogue are for reference only, JENG SHI reserves the right to alter or revise the specifications without prior notification.

\*Beyond the above specification also can meet the special requirements. Need detailed content Please to the website query or contact us.

## Standard Specifications

Stamp	Inductance (uH)	Tolerance	Q (Min)	DCR (Ω) Max	Test frequency (MHz)	Test voltage (mV)	SRF (MHz) Min	Rated current (mA) Max
SCCI201209TL-47N	0.047	±10%	25	0.15	50	50	320	300
SCCI201209TL-56N	0.056	±10%	25	0.15	50	50	320	300
SCCI201209TL-68N	0.068	±10%	25	0.20	50	50	280	300
SCCI201209TL-82N	0.082	±10%	25	0.20	50	50	280	300
SCCI201209TL-R10	0.10	±10%	20	0.20	25	50	235	250
SCCI201209TL-R12	0.12	±10%	20	0.25	25	50	220	250
SCCI201209TL-R15	0.15	±10%	20	0.25	25	50	200	250
SCCI201209TL-R18	0.18	±10%	20	0.30	25	50	185	250
SCCI201209TL-R22	0.22	±10%	20	0.30	25	50	170	250
SCCI201209TL-R27	0.27	±10%	20	0.40	25	50	150	250
SCCI201209TL-R33	0.33	±10%	20	0.40	25	50	145	250
SCCI201209TL-R39	0.39	±10%	25	0.50	25	50	135	200
SCCI201209TL-R47	0.47	±10%	25	0.50	25	50	125	200
SCCI201209TL-R56	0.56	±10%	25	0.60	25	50	115	150
SCCI201209TL-R68	0.68	±10%	25	0.65	25	50	105	150
SCCI201209TL-R82	0.82	±10%	25	0.70	25	50	100	150
SCCI201209TL-1R0	1.00	±10%	35	0.40	10	50	75	50
SCCI201209TL-1R2	1.20	±10%	35	0.40	10	50	65	50
SCCI201209TL-1R5	1.50	±10%	35	0.40	10	50	60	50
SCCI201209TL-1R8	1.80	±10%	35	0.40	10	50	55	50
SCCI201209TL-2R2	2.20	±10%	35	0.60	10	50	50	50
SCCI201209TL-2R7	2.70	±10%	35	0.60	10	50	45	50
SCCI201209TL-3R3	3.30	±10%	35	0.60	10	50	41	50
SCCI201209TL-3R9	3.90	±10%	35	0.80	10	50	38	50
SCCI201209TL-4R7	4.70	±10%	35	0.90	10	50	35	30
SCCI201209TL-5R6	5.60	±10%	30	1.00	4	50	32	15
SCCI201209TL-6R8	6.80	±10%	30	1.05	4	50	29	15
SCCI201209TL-8R2	8.20	±10%	30	1.05	4	50	26	15
SCCI201209TL-100	10.00	±10%	30	1.15	2	50	24	15
SCCI201209TL-120	12.00	±10%	30	1.15	2	50	22	15
SCCI201209TL-150	15.00	±10%	25	1.15	1	50	19	5
SCCI201209TL-180	18.00	±10%	25	1.20	1	50	18	5
SCCI201209TL-220	22.00	±10%	25	1.20	1	50	16	5
SCCI201209TL-270	27.00	±10%	25	1.50	1	50	16	5
SCCI201209TL-330	33.00	±20%	25	1.50	1	50	16	5
SCCI201209TL-390	39.00	±20%	25	1.50	1	50	16	5
SCCI201209TL-470	47.00	±20%	25	1.70	1	50	15	5

Note: When ordering, please specify tolerance code. Tolerance: K=±10%, M=±20%

\*All the data listed in this catalogue are for reference only, JENG SHI reserves the right to alter or revise the specifications without prior notification.

\*Beyond the above specification also can meet the special requirements. Need detailed content Please to the website query or contact us.

## Standard Specifications

Stamp	Inductance (uH)	Tolerance	Q (Min)	DCR (Ω) Max	Test frequency (MHz)	Test voltage (mV)	SRF (MHz) Min	Rated current (mA) Max
SCCI321609TL-47N	0.047	±10%	30	0.15	50	50	320	300
SCCI321609TL-56N	0.056	±10%	30	0.20	50	50	320	300
SCCI321609TL-68N	0.068	±10%	30	0.25	50	50	280	300
SCCI321609TL-82N	0.082	±10%	30	0.25	50	50	280	300
SCCI321609TL-R10	0.10	±10%	25	0.25	25	50	235	250
SCCI321609TL-R12	0.12	±10%	25	0.25	25	50	220	250
SCCI321609TL-R15	0.15	±10%	25	0.25	25	50	200	250
SCCI321609TL-R18	0.18	±10%	25	0.30	25	50	185	250
SCCI321609TL-R22	0.22	±10%	25	0.30	25	50	170	250
SCCI321609TL-R27	0.27	±10%	25	0.30	25	50	150	250
SCCI321609TL-R33	0.33	±10%	25	0.30	25	50	145	250
SCCI321609TL-R39	0.39	±10%	30	0.50	25	50	135	200
SCCI321609TL-R47	0.47	±10%	30	0.50	25	50	125	200
SCCI321609TL-R56	0.56	±10%	30	0.50	25	50	115	150
SCCI321609TL-R68	0.68	±10%	30	0.50	25	50	105	150
SCCI321609TL-R82	0.82	±10%	30	0.60	25	50	100	150
SCCI321609TL-1R0	1.00	±10%	35	0.30	10	50	75	100
SCCI321609TL-1R2	1.20	±10%	35	0.40	10	50	65	100
SCCI321609TL-1R5	1.50	±10%	35	0.40	10	50	60	50
SCCI321609TL-1R8	1.80	±10%	35	0.40	10	50	55	50
SCCI321609TL-2R2	2.20	±10%	35	0.50	10	50	50	50
SCCI321609TL-2R7	2.70	±10%	35	0.50	10	50	45	50
SCCI321609TL-3R3	3.30	±10%	35	0.50	10	50	41	50
SCCI321609TL-3R9	3.90	±10%	35	0.60	10	50	38	50
SCCI321609TL-4R7	4.70	±10%	35	0.65	10	50	35	25
SCCI321609TL-5R6	5.60	±10%	35	0.80	4	50	32	25
SCCI321609TL-6R8	6.80	±10%	35	0.80	4	50	29	25
SCCI321609TL-8R2	8.20	±10%	35	0.80	4	50	26	25
SCCI321609TL-100	10.00	±10%	35	0.80	2	50	24	25
SCCI321609TL-120	12.00	±10%	35	0.90	2	50	22	15
SCCI321609TL-150	15.00	±10%	30	1.00	1	50	19	5
SCCI321609TL-180	18.00	±10%	30	1.00	1	50	18	5
SCCI321609TL-220	22.00	±10%	30	1.20	1	50	16	5
SCCI321609TL-270	27.00	±10%	30	1.20	1	50	14	5
SCCI321609TL-330	33.00	±10%	30	1.30	1	50	13	5
SCCI321609TL-390	39.00	±10%	30	1.30	1	50	13	5
SCCI321609TL-470	47.00	±10%	30	1.60	1	50	12	5
SCCI321609TL-560	56.00	±20%	30	1.80	1	50	12	5
SCCI321609TL-680	68.00	±20%	30	2.00	1	50	11	5
SCCI321609TL-820	82.00	±20%	30	2.40	1	50	11	5
SCCI321609TL-101	100.00	±20%	30	3.00	1	50	8	5

Note: When ordering, please specify tolerance code. Tolerance: K=±10%, M=±20%

\*All the data listed in this catalogue are for reference only, JENG SHI reserves the right to alter or revise the specifications without prior notification.

\*Beyond the above specification also can meet the special requirements. Need detailed content Please to the website query or contact us.

## Standard Specifications

Stamp	Inductance (uH)	Tolerance	Q (Min)	DCR (Ω) Max	Test frequency (MHz)	Test voltage (mV)	SRF (MHz) Min	Rated current (mA) Max
SCCI322513TL-1R0	1.0	±10%	40	0.20	10	50	70	600
SCCI322513TL-1R2	1.2	±10%	40	0.20	10	50	70	600
SCCI322513TL-1R5	1.5	±10%	40	0.30	10	50	70	500
SCCI322513TL-1R8	1.8	±10%	40	0.30	10	50	70	500
SCCI322513TL-2R2	2.2	±10%	40	0.30	10	50	50	500
SCCI322513TL-2R7	2.7	±10%	40	0.30	10	50	50	500
SCCI322513TL-3R3	3.3	±10%	40	0.40	10	50	50	500
SCCI322513TL-3R9	3.9	±10%	40	0.40	10	50	30	500
SCCI322513TL-4R7	4.7	±10%	40	0.50	10	50	30	500
SCCI322513TL-5R6	5.6	±10%	35	0.60	4	50	30	450
SCCI322513TL-6R8	6.8	±10%	35	0.60	4	50	20	450
SCCI322513TL-8R2	8.2	±10%	35	0.70	4	50	20	400
SCCI322513TL-100	10.0	±10%	35	0.70	2	50	20	400
SCCI322513TL-120	12.0	±10%	35	0.70	2	50	20	400
SCCI322513TL-150	15.0	±10%	35	0.70	1	50	20	300
SCCI322513TL-180	18.0	±10%	35	0.70	1	50	10	300
SCCI322513TL-220	22.0	±10%	35	0.75	1	50	10	250
SCCI322513TL-270	27.0	±10%	35	0.75	1	50	10	250
SCCI322513TL-330	33.0	±10%	35	0.80	1	50	10	250
SCCI322513TL-390	39.0	±10%	35	0.80	1	50	10	250
SCCI322513TL-470	47.0	±10%	35	1.00	1	50	10	200
SCCI322513TL-560	56.0	±20%	35	1.20	1	50	5	200
SCCI322513TL-680	68.0	±20%	35	1.30	1	50	5	150
SCCI322513TL-820	82.0	±20%	35	1.50	1	50	5	150
SCCI322513TL-101	100.0	±20%	35	1.50	1	50	5	150
SCCI322513TL-121	120.0	±20%	35	1.80	1	50	5	150

Note: When ordering, please specify tolerance code. Tolerance: K=±10%, M=±20%

\*All the data listed in this catalogue are for reference only, JENG SHI reserves the right to alter or revise the specifications without prior notification.

\*Beyond the above specification also can meet the special requirements. Need detailed content Please to the website query or contact us.

## Standard Specifications

Stamp	Inductance (uH)	Tolerance	Q (Min)	DCR (Ω) Max	Test frequency (MHz)	Test voltage (mV)	SRF (MHz) Min	Rated current (mA) Max
SCCI453215TL-1R0	1.0	±10%	35	0.55	10	50	50	650
SCCI453215TL-1R2	1.2	±10%	35	0.55	10	50	50	650
SCCI453215TL-1R5	1.5	±10%	35	0.55	10	50	45	600
SCCI453215TL-1R8	1.8	±10%	35	0.65	10	50	45	600
SCCI453215TL-2R2	2.2	±10%	35	0.65	10	50	40	500
SCCI453215TL-2R7	2.7	±10%	35	0.70	10	50	40	500
SCCI453215TL-3R3	3.3	±10%	35	0.75	10	50	35	500
SCCI453215TL-3R9	3.9	±10%	35	0.80	10	50	35	500
SCCI453215TL-4R7	4.7	±10%	30	0.90	10	50	25	500
SCCI453215TL-5R6	5.6	±10%	30	0.90	4	50	20	500
SCCI453215TL-6R8	6.8	±10%	30	1.00	4	50	18	500
SCCI453215TL-8R2	8.2	±10%	30	1.00	4	50	17	450
SCCI453215TL-100	10.0	±10%	30	1.00	2	50	16	450
SCCI453215TL-120	12.0	±10%	35	1.00	2	50	15	450
SCCI453215TL-150	15.0	±10%	35	1.00	1	50	14	400
SCCI453215TL-180	18.0	±10%	35	1.00	1	50	13	400
SCCI453215TL-220	22.0	±10%	35	1.30	1	50	12	300
SCCI453215TL-270	27.0	±10%	35	1.30	1	50	10	300
SCCI453215TL-330	33.0	±10%	40	1.50	1	50	10	250
SCCI453215TL-390	39.0	±10%	40	1.50	1	50	10	250
SCCI453215TL-470	47.0	±10%	40	1.65	1	50	8	250
SCCI453215TL-560	56.0	±10%	40	1.80	1	50	8	250
SCCI453215TL-680	68.0	±20%	40	2.00	1	50	6	200
SCCI453215TL-820	82.0	±20%	40	2.30	1	50	6	200
SCCI453215TL-101	100.0	±20%	40	2.30	1	50	6	150
SCCI453215TL-121	120.0	±20%	40	2.30	1	50	6	150

Note: When ordering, please specify tolerance code. Tolerance: K=±10%, M=±20%

\*All the data listed in this catalogue are for reference only, JENG SHI reserves the right to alter or revise the specifications without prior notification.

\*Beyond the above specification also can meet the special requirements. Need detailed content Please to the website query or contact us.