

EMI Ferrite Core—UH Series

UH Series



Features

Excellent heat resistance
 Available in various sizes & materials
 High reliability

Applications

E.M.I. Suppression on round cable...
 Computer and peripheral products
 Consumer electronic products
 Communication electronic products
 Measuring instruments

Product Identification

S X X U H X x X x X - X X (X X X X X)
 For example: S25 UH 26x29.2x13-S6B (1330R)

General Specifications

Test Frequency.....25MHz
 Test Frequency.....100MHz
 Parameters Test Temp..... 25℃
 Operation Temp.....-20℃ to +85℃
 (Including temperature Rise)
 Storage Temp.....0~40℃
 Storage Humidity.....<70% RH

Shape

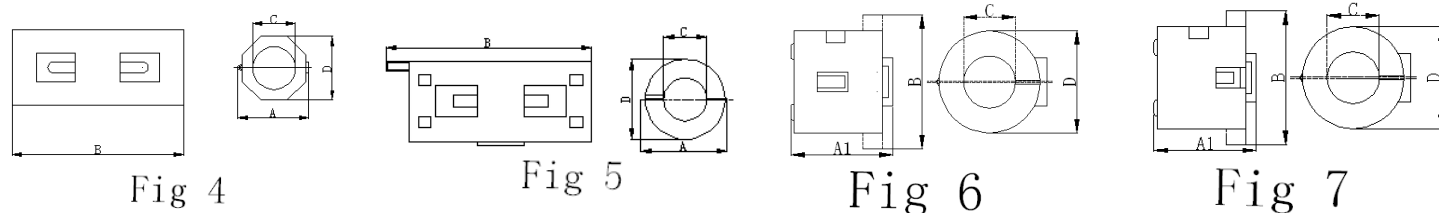
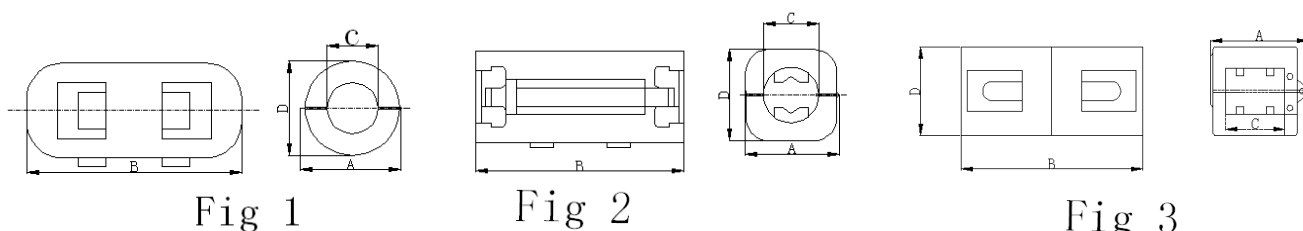

Standard Specifications And Dimensions

Stamp	Impedance 25MHz (Ω)Typ	Impedance 100MHz (Ω)Typ	Fig	Dimensions In mm				
				A	B	C	D	Cable Diameter (Max.)
S30 UH 8.4x15.5x3.8-S9 (LF-35)	60	120	1	15.50±1.0	25.50±1.0	4.30±1.0	15.00±1.0	φ 3.0
S36 UH 10x15x6-F23 (S-10)	40	70	4	14.50±1.0	18.00±1.0	6.50±1.0	13.00±1.0	φ 5.0
S30 UH 10.1x20x5-S9 (0530A)	60	120	2	15.20±1.0	23.50±1.0	6.50±1.0	14.50±1.0	φ 3.5
S30 UH 10.1x21x5.3-S9 (LF-50)	65	130	1	17.00±1.0	29.50±1.0	5.50±1.0	15.50±1.0	φ 4.5
S30 UH 10.1x21x5.3-S9 (LF-50S)	65	130	3	15.20±1.0	23.50±1.0	6.50±1.0	14.50±1.0	φ 4.5
S30 UH 12x15x7-S9 (0730)	35	70	5	16.00±1.0	22.50±1.0	7.50±1.0	14.50±1.0	φ 6.0
S30 UH 13x23x5.2-S9 (0730A)	95	190	1	16.50±1.0	30.50±1.0	7.00±1.0	14.50±1.0	φ 3.5
S30 UH 13x23x7-S9 (0730A)	70	150	2	16.50±1.0	30.50±1.0	7.00±1.0	14.50±1.0	φ 6.0
S28 UH 16x13x8-S6 (LF-801)	30	80	7	23.50±1.0	23.00±1.0	8.50±1.0	19.50±1.0	φ 7.5
S28 UH 16x16x8-S6 (LF-802)	40	100	7	23.00±1.0	26.00±1.0	8.00±1.0	19.50±1.0	φ 7.5
S25 UH 16x28x9-S6B (0930)	80	150	5	20.00±1.0	35.50±1.0	10.00±1.0	18.00±1.0	φ 8.5

* All the data listed in this catalogue are for reference only, JENG SHI reserves the right to alter or revise the specifications without prior notification.

* Beyond the above specification also can meet the special requirements. Need detailed content Please to the website query or contact us.

Standard Specifications And Dimensions

Stamp	Impedance 25MHz (Ω)Min	Impedance 100MHz (Ω)Min	Fig	Dimensions In mm				
				A	B	C	D	Cable Diameter (Max.)
S25 UH 16x28x9-S6B (0930A)	60	130	1	20.00±1.0	35.50±1.0	10.00±1.0	18.00±1.0	φ 7.0
S28 UH 17.2x28x10-S6 (1130)	70	130	5	21.00±1.0	36.50±1.0	12.00±1.0	21.00±1.0	φ 9.5
S28 UH 17.2x28x11-S6 (1130)	65	140	5	20.50±1.0	36.00±1.0	9.50±1.0	19.00±1.0	φ 10.0
S28 UH 18x28x10-S6 (1030A)	80	140	1	21.50±1.0	35.50±1.0	10.50±1.0	20.50±1.0	φ 9.0
S28 UH 19x30x10.2-S6 (LF-100S)	90	160	3	25.00±1.0	32.50±1.0	12.00±1.0	23.50±1.0	φ 9.0
S28 UH 20x29x13-S6 (1330A)	65	110	1	24.00±1.0	36.00±1.0	13.50±1.0	22.00±1.0	φ 12.0
S28 UH 20.5x10x10-S6 (LF-100R)	20	70	7	28.50±1.0	19.50±1.0	10.00±1.0	25.00±1.0	φ 9.5
S28 UH 24x14x12-S6 (LF-120)	45	100	7	31.50±1.0	23.00±1.0	12.00±1.0	28.00±1.0	φ 11.0
S28 UH 25x12x15-S6 (LF-150)	35	85	7	33.50±1.0	20.50±1.0	14.50±1.0	29.00±1.0	φ 14.0
S25 UH 15x29.5x6.5-S6B (LF-65S)	110	200	3	20.00±1.0	33.00±1.0	8.50±1.0	19.50±1.0	φ 5.8
S28 UH 15.5x29.5x7.5-S6 (LF-75)	130	220	2	21.00±1.0	39.00±1.0	8.00±1.0	20.50±1.0	φ 7.5
S25 UH 26x29.2x13-S6B (1330R)	80	160	5	31.50±1.0	39.00±1.0	13.00±1.0	30.00±1.0	φ 12.0
S25 UH 26x29.5x13-S6B (LF-130S)	80	180	3	30.50±1.0	33.00±1.0	13.00±0.6	30.00±1.0	φ 12.0
S30 UH 26x38.9x19.4-S9 (LF-190S)	80	160	3	32.00±1.0	42.00±1.0	19.50±1.0	30.00±1.0	φ 18.0

*All the data listed in this catalogue are for reference only, JENG SHI reserves the right to alter or revise the specifications without prior notification.

*Beyond the above specification also can meet the special requirements. Need detailed content Please to the website query or contact us.