

## T Series

### Features

One hole rod type  
 Excellent heat resistance.  
 Available in various sizes & materials  
 High reliability.

### Applications

E.M.I. Suppression on round cable...  
 Computer and peripheral products  
 Consumer electronic products  
 Communication electronic products  
 Measuring instruments

### Product Identification

T XXXXX  
 For example:T 2.5X1.3X1.3

### General Specifications

Test Frequency.....25MHz  
 Test Frequency.....100MHz  
 Parameters Test Temp..... 25℃  
 Operation Temp.....-20℃ to +85℃  
 (Including temperature Rise)  
 Storage Temp.....0~-40℃  
 Storage Humidity.....<70% RH

## Shape

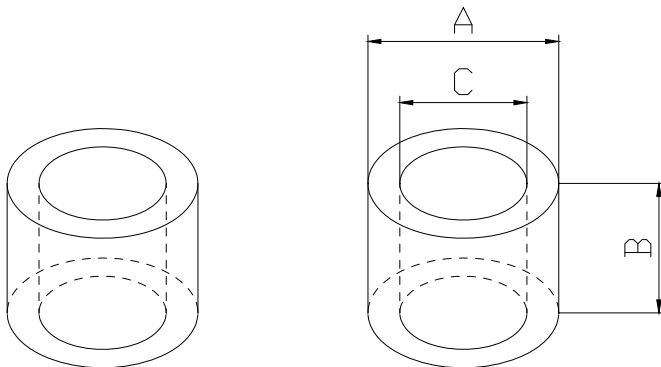

## Standard Specifications And Dimensions

Stamp	Impedance 25MHz (Ω)Min	Impedance 100MHz (Ω)Min	Dimensions In mm		
			A	B	C
T 2.5X1.3X1.3	10	40	2.50±0.3	1.30±0.3	1.30±0.3
T 3X3X1.2	20	65	3.00±0.3	3.00±0.3	1.20±0.3
T 3.5X2X1.8	15	45	3.50±0.4	2.00±0.4	1.80±0.3
T 3.5X3X0.8	30	80	3.50±0.4	3.00±0.4	0.80±0.3
T 3.5X3X1.0	25	75	3.50±0.4	3.00±0.4	1.00±0.3
T 3.5X3X1.8	18	60	3.50±0.4	3.00±0.4	1.80±0.3
T 3.5X3.2X1.6	20	65	3.50±0.4	3.20±0.4	1.60±0.3
T 4X1X2	12	55	4.00±0.4	1.00±0.3	2.00±0.3
T 4X2X2	15	60	4.00±0.4	2.00±0.4	2.00±0.3
T 4X3X2	20	65	4.00±0.4	3.00±0.4	2.00±0.3
T 4X4X1.5	25	70	4.00±0.4	4.00±0.4	1.50±0.3
T 4X4X2	20	65	4.00±0.4	4.00±0.4	2.00±0.3
T 5X2.5X3	15	55	5.00±0.4	2.50±0.4	3.00±0.3
T 5X4X3	20	65	5.00±0.4	4.00±0.4	3.00±0.3
T 5X5X3	25	70	5.00±0.4	5.00±0.4	3.00±0.3
T 6X2X3	15	60	6.00±0.4	2.00±0.3	3.00±0.3
T 6X3X3	20	65	6.00±0.4	3.00±0.4	3.00±0.3
T 6X3X4	15	60	6.00±0.4	3.00±0.4	4.00±0.4
T 6X4X3	25	70	6.00±0.4	4.00±0.4	3.00±0.3
T 6X4X4	20	65	6.00±0.4	4.00±0.4	4.00±0.4

\* All the data listed in this catalogue are for reference only, JENG SHI reserves the right to alter or revise the specifications without prior notification.

\* Beyond the above specification also can meet the special requirements. Need detailed content Please to the website query or contact us.

## Standard Specifications And Dimensions

Stamp	Impedance 25MHz (Ω)Min	Impedance 100MHz (Ω)Min	Dimensions In mm		
			A	B	C
T 6X6X3	25	75	6.00±0.4	6.00±0.4	3.00±0.3
T 6X6X4	20	65	6.00±0.4	6.00±0.4	4.00±0.4
T 6.5X5X4	20	70	6.50±0.4	5.00±0.4	4.00±0.4
T 6.5X5X4.3	20	65	6.50±0.4	5.00±0.4	4.30±0.4
T 7X7X4	25	80	7.00±0.4	7.00±0.4	4.00±0.4
T 7.6X2X5.3	15	60	7.60±0.4	2.00±0.4	5.30±0.4
T 7.6X3.6X4.2	20	70	7.60±0.4	3.60±0.4	4.20±0.4
T 7.6X5X5.2	20	65	7.60±0.4	5.00±0.4	5.20±0.4
T 7.6X6X5	20	70	7.60±0.4	6.00±0.4	5.00±0.4
T 8X2X4	15	60	8.00±0.4	2.00±0.4	4.00±0.4
T 8X3X4	20	65	8.00±0.4	3.00±0.4	4.00±0.4
T 8X4X4	25	70	8.00±0.4	4.00±0.4	4.00±0.4
T 8X6.3X5.6	20	65	8.00±0.4	6.30±0.4	5.60±0.4
T 8X7X6	18	65	8.00±0.4	7.00±0.4	6.00±0.4
T 8X7.5X5.3	20	75	8.00±0.4	7.50±0.4	5.30±0.4
T 8X8X4	35	90	8.00±0.4	8.00±0.4	4.00±0.4
T 9X3X5	20	60	9.00±0.4	3.00±0.4	5.00±0.4
T 9X4.5X5	20	70	9.00±0.4	4.50±0.4	5.00±0.4
T 9.1X4.6X5	20	70	9.10±0.4	4.60±0.4	5.00±0.4
T 9X8X5	30	80	9.00±0.4	8.00±0.4	5.00±0.4
T 9.5X5X5	20	70	9.50±0.4	5.00±0.4	5.00±0.4
T 9.5X9.5X5	35	90	9.50±0.4	9.50±0.4	5.00±0.4
T 9.8X6.5X6	25	75	9.80±0.4	6.50±0.4	6.00±0.4
T 10X2X6	12	50	10.0±0.4	2.00±0.4	6.00±0.4
T 10X3X6	15	55	10.0±0.4	3.00±0.4	6.00±0.4
T 10X4X6	15	60	10.0±0.4	4.00±0.4	6.00±0.4
T 10X4X7	18	65	10.0±0.4	4.00±0.4	7.00±0.4
T 10X5X5	25	70	10.0±0.4	5.00±0.4	5.00±0.4
T 10X5X6	20	65	10.0±0.4	5.00±0.4	6.00±0.4
T 10X6X6	25	75	10.0±0.4	6.00±0.4	6.00±0.4
T 10X5X7	20	65	10.0±0.4	5.00±0.4	7.00±0.4
T 10X7X6	25	75	10.0±0.4	7.00±0.4	6.00±0.4
T 10X7.5X6	25	80	10.0±0.4	7.50±0.4	6.00±0.4
T 10X7X7	20	70	10.0±0.4	7.00±0.4	7.00±0.4
T 10X7.5X7	22	72	10.0±0.4	7.50±0.4	7.00±0.4
T 10X8X6	30	80	10.0±0.4	8.00±0.4	6.00±0.4
T 10X10X4.2	55	115	10.0±0.4	10.0±0.4	4.20±0.4
T 10X10X5	35	85	10.0±0.4	10.0±0.4	5.00±0.4
T 10X10X6	30	80	10.0±0.4	10.0±0.4	6.00±0.4
T 10X10X7	25	75	10.0±0.4	10.0±0.4	7.00±0.4
T 10.5X10X7.3	25	75	10.5±0.4	10.0±0.4	7.30±0.4
T 10X20X4.2	100	200	10.0±0.4	20.0±0.6	4.20±0.4

\* All the data listed in this catalogue are for reference only, JENG SHI reserves the right to alter or revise the specifications without prior notification.

\* Beyond the above specification also can meet the special requirements. Need detailed content Please to the website query or contact us.

## Standard Specifications And Dimensions

Stamp	Impedance 25MHz ( $\Omega$ )Min	Impedance 100MHz ( $\Omega$ )Min	Dimensions In mm		
			A	B	C
T 11X8X5	30	90	11.0±0.5	8.00±0.4	5.00±0.4
T 12X4X6	25	70	12.0±0.5	4.00±0.4	6.00±0.4
T 12X5X8	20	65	12.0±0.5	5.00±0.4	8.00±0.4
T 12X5.3X7.3	20	65	12.0±0.5	5.30±0.4	7.30±0.4
T 12X5.5X7	20	70	12.0±0.5	5.50±0.4	7.00±0.4
T 12X6X6	25	80	12.0±0.5	6.00±0.4	6.00±0.4
T 12X6X7.3	20	70	12.0±0.5	6.00±0.4	7.30±0.4
T 12X7X8	20	70	12.0±0.5	7.00±0.4	8.00±0.4
T 12X8X6	35	85	12.0±0.5	8.00±0.4	6.00±0.4
T 12X8X7	30	85	12.0±0.5	8.00±0.4	7.00±0.4
T 12X9X5.6	40	105	12.0±0.5	9.00±0.4	5.60±0.4
T 12X10X3.55	85	180	12.0±0.5	10.0±0.4	3.50±0.4
T 12X10X7	35	85	12.0±0.5	10.0±0.4	7.00±0.4
T 12X12X5.6	45	110	12.0±0.5	12.0±0.5	5.60±0.4
T 12X12X6.5	40	95	12.0±0.5	12.0±0.5	6.50±0.4
T 12X12X8	35	90	12.0±0.5	12.0±0.5	8.00±0.4
T 12.5X6.5X5	35	85	12.5±0.5	6.50±0.4	5.00±0.4
T 12.5X12X8	35	90	12.5±0.5	12.0±0.5	8.00±0.4
T 12.7X6.35X7.9	25	70	12.7±0.5	6.35±0.4	7.90±0.4
T 12.7X4.8X7.9	20	60	12.7±0.5	4.80±0.4	7.90±0.4
T 12.7X9.6X7.9	30	90	12.7±0.5	9.60±0.4	7.90±0.4
T 12.7X12.7X7.3	45	100	12.7±0.5	12.7±0.5	7.30±0.4
T 12.7X12.7X7.9	40	95	12.7±0.5	12.7±0.5	7.90±0.4
T 12.7X12.7X11	20	70	12.7±0.5	12.7±0.5	11.0±0.5
T 13X3X7	20	65	13.0±0.5	3.00±0.4	7.00±0.4
T 13X6.3X7	25	75	13.0±0.5	6.30±0.4	7.00±0.4
T 13X6.5X8	20	70	13.0±0.5	6.50±0.4	8.00±0.4
T 13X7X7	30	80	13.0±0.5	7.00±0.4	7.00±0.4
T 13X10X8.2	30	85	13.0±0.5	10.0±0.4	8.20±0.4
T 13X12.7X7.1	40	100	13.0±0.5	12.7±0.5	7.10±0.4
T 14X4X8	15	65	14.0±0.5	4.00±0.4	8.00±0.4
T 14X5X8	20	70	14.0±0.5	5.00±0.4	8.00±0.4
T 14X5X9	15	65	14.0±0.5	5.00±0.4	9.00±0.5
T 14X5.5X9	18	70	14.0±0.5	5.50±0.4	9.00±0.5
T 14X14X10	35	90	14.0±0.5	14.0±0.5	10.0±0.5
T 14.2X5X10	20	65	14.2±0.5	5.00±0.4	10.0±0.5
T 14.2X5.5X8.7	20	70	14.2±0.5	5.50±0.4	8.70±0.4
T 14.2X7X8	25	80	14.2±0.5	7.00±0.4	8.00±0.4
T 14.2X8X9	20	75	14.2±0.5	8.00±0.4	9.00±0.5
T 14.2X8X10	18	70	14.2±0.5	8.00±0.4	10.0±0.5
T 14.2X10X8	35	95	14.2±0.5	10.0±0.4	8.00±0.4
T 14.2X10.16X6.35	40	100	14.2±0.5	10.16±0.4	6.35±0.4

\* All the data listed in this catalogue are for reference only, JENG SHI reserves the right to alter or revise the specifications without prior notification.

\* Beyond the above specification also can meet the special requirements. Need detailed content Please to the website query or contact us.

## Standard Specifications And Dimensions

Stamp	Impedance 25MHz ( $\Omega$ )Min	Impedance 100MHz ( $\Omega$ )Min	Dimensions In mm		
			A	B	C
T 14.2X12X7.8	45	105	14.2±0.5	12.0±0.5	7.80±0.4
T 14.2X12.7X6.7	50	110	14.2±0.5	12.7±0.5	6.70±0.4
T 14.2X13X8	45	105	14.2±0.5	13.0±0.5	8.00±0.4
T 14.2X13.8X6.35	50	130	14.2±0.5	13.8±0.5	6.35±0.4
T 14.5X8X10	25	70	14.5±0.5	8.00±0.4	10.0±0.5
T 15X5X10	20	65	15.0±0.5	5.00±0.4	10.0±0.5
T 15X15X10.5	30	90	15.0±0.5	15.0±0.5	10.5±0.5
T 15.2X12.5X10.5	25	85	15.2±0.5	12.5±0.5	10.5±0.5
T 15.6X14X13.4	20	75	15.6±0.5	14.0±0.5	13.4±0.5
T 15.87X14.3X7.9	55	125	15.87±0.5	14.3±0.5	7.90±0.4
T 16X4X9	20	70	16.0±0.5	4.00±0.4	9.00±0.5
T 16X4X10	20	65	16.0±0.5	4.00±0.4	10.0±0.5
T 16X5X10	20	70	16.0±0.5	5.00±0.4	10.0±0.5
T 16X5.4X9	20	70	16.0±0.5	5.40±0.4	9.00±0.5
T 16X7X9	30	80	16.0±0.5	7.00±0.4	9.00±0.5
T 16X7X10	25	75	16.0±0.5	7.00±0.4	10.0±0.5
T 16X8X10	25	80	16.0±0.5	8.00±0.4	10.0±0.5
T 16X8X12	20	70	16.0±0.5	8.00±0.4	12.0±0.5
T 16X10X7	40	105	16.0±0.5	10.0±0.4	7.00±0.4
T 16X10X8	38	100	16.0±0.5	10.0±0.4	8.00±0.4
T 16X10X9	35	95	16.0±0.5	10.0±0.4	9.00±0.5
T 16X10X10	30	85	16.0±0.5	10.0±0.4	10.0±0.5
T 16X10X12	25	75	16.0±0.5	10.0±0.4	12.0±0.5
T 16X12X9.5	30	90	16.0±0.5	12.0±0.5	9.50±0.5
T 16X12X10	28	85	16.0±0.5	12.0±0.5	10.0±0.5
T 16X13X8	45	115	16.0±0.5	13.0±0.5	8.00±0.4
T 16X13X9	40	100	16.0±0.5	13.0±0.5	9.00±0.5
T 16X14X10	40	100	16.0±0.5	14.0±0.5	10.0±0.5
T 16X15X9	50	115	16.0±0.5	15.0±0.5	9.00±0.5
T 16X16X8	65	130	16.0±0.5	16.0±0.5	8.00±0.4
T 16X16X9	50	115	16.0±0.5	16.0±0.5	9.00±0.5
T 16X16X10	45	110	16.0±0.5	16.0±0.5	10.0±0.5
T 17.5X6.35X9.5	25	75	17.5±0.6	6.35±0.4	9.50±0.5
T 17.5X7X9.6	30	85	17.5±0.6	7.00±0.4	9.60±0.5
T 17.5X9.5X12.7	25	80	17.5±0.6	9.50±0.4	12.7±0.5
T 17.5X10X8	40	100	17.5±0.6	10.0±0.4	8.00±0.4
T 17.5X11X9.5	40	90	17.5±0.6	11.0±0.5	9.50±0.5
T 17.5X12X11.3	30	85	17.5±0.6	12.0±0.5	11.3±0.5
T 17.5X12.5X12	25	80	17.5±0.6	12.5±0.5	12.0±0.5
T 17.5X12.7X9.5	45	110	17.5±0.6	12.7±0.5	9.50±0.5
T 17.5X12.7X10.7	40	95	17.5±0.6	12.7±0.5	10.7±0.5
T 17.5X13.5X9.5	50	110	17.5±0.6	13.5±0.5	9.50±0.5

\* All the data listed in this catalogue are for reference only, JENG SHI reserves the right to alter or revise the specifications without prior notification.

\* Beyond the above specification also can meet the special requirements. Need detailed content Please to the website query or contact us.

## Standard Specifications And Dimensions

Stamp	Impedance 25MHz (Ω)Min	Impedance 100MHz (Ω)Min	Dimensions In mm		
			A	B	C
T 17.5x15x9.5	55	125	17.5±0.6	15.0±0.5	9.50±0.5
T 18x6x10	25	75	18.0±0.6	6.00±0.4	10.0±0.5
T 18x7x10	30	80	18.0±0.6	7.00±0.4	10.0±0.5
T 18x8x10	30	85	18.0±0.6	8.00±0.4	10.0±0.5
T 18x10x10	35	90	18.0±0.6	10.0±0.4	10.0±0.5
T 18x12x10	45	105	18.0±0.6	12.0±0.5	10.0±0.5
T 18x12x12	30	85	18.0±0.6	12.0±0.5	12.0±0.5
T 18x14x10	50	110	18.0±0.6	14.0±0.5	10.0±0.5
T 18x15x10	50	120	18.0±0.6	15.0±0.5	10.0±0.5
T 18x18x10	60	130	18.0±0.6	18.0±0.6	10.0±0.5
T 18.2x6.4x11.2	20	75	18.2±0.6	6.40±0.4	11.2±0.5
T 18.2x6.5x10	25	80	18.2±0.6	6.50±0.4	10.0±0.5
T 18.4x9.6x12.5	25	85	18.4±0.6	9.60±0.4	12.5±0.5
T 18.5x12.5x9.5	45	110	18.2±0.6	12.5±0.5	9.50±0.5
T 18.4x14.3x9.5	50	115	18.4±0.6	14.3±0.5	9.50±0.5
T 19x11x13	30	80	19.0±0.6	11.0±0.5	13.0±0.5
T 19.5x12.7x9.5	50	120	19.5±0.6	12.7±0.5	9.50±0.5
T 20x5x10	25	75	20.0±0.6	5.00±0.4	10.0±0.5
T 20x7x10	30	80	20.0±0.6	7.00±0.4	10.0±0.5
T 20x8x10	35	90	20.0±0.6	8.00±0.4	10.0±0.5
T 20x10x10	40	95	20.0±0.6	10.0±0.4	10.0±0.5
T 20x15x10	65	135	20.0±0.6	15.0±0.5	10.0±0.5
T 20.8x30x11.6	90	200	20.8±0.6	30.0±0.5	11.6±0.5
T 21x6x12.7	20	75	21.0±0.6	6.00±0.4	12.7±0.5
T 21x12x13.2	30	85	21.0±0.6	12.0±0.5	13.2±0.5
T 21x13x12	35	95	21.0±0.6	13.0±0.5	12.0±0.5
T 22x8x14	30	80	22.0±0.6	8.00±0.4	14.0±0.5
T 22.5x6.4x13.8	25	75	22.5±0.6	6.40±0.4	13.8±0.5
T 22.5x6.4x14.3	25	70	22.5±0.6	6.40±0.4	14.3±0.5
T 22.5x8x13.8	30	80	22.5±0.6	8.00±0.4	13.8±0.5
T 22.5x9.5x13.5	30	85	22.5±0.6	9.50±0.4	13.5±0.5
T 22.5x10x13.8	35	90	22.5±0.6	10.0±0.4	13.8±0.5
T 22.5x12.7x13.5	40	95	22.5±0.6	12.7±0.5	13.5±0.5
T 23x10x8	20	70	23.0±0.6	10.0±0.4	18.0±0.4
T 23.5x9.5x12.7	35	90	23.6±0.6	9.50±0.4	12.7±0.5
T 24x14x11.4	50	120	24.0±0.6	14.0±0.5	11.4±0.5
T 25x8x15	25	80	25.0±0.6	8.00±0.4	15.0±0.5
T 25x10x15	30	85	25.0±0.6	10.0±0.4	15.0±0.5
T 25x12x15	40	95	25.0±0.6	12.0±0.5	15.0±0.5
T 25x15x13	55	125	25.0±0.6	15.0±0.5	13.0±0.5
T 25x15x15	45	110	25.0±0.6	15.0±0.5	15.0±0.5
T 26x8x16	25	80	26.0±0.6	8.00±0.4	16.0±0.6

\* All the data listed in this catalogue are for reference only, JENG SHI reserves the right to alter or revise the specifications without prior notification.

\* Beyond the above specification also can meet the special requirements. Need detailed content Please to the website query or contact us.

## Standard Specifications And Dimensions

Stamp	Impedance 25MHz ( $\Omega$ )Min	Impedance 100MHz ( $\Omega$ )Min	Dimensions In mm		
			A	B	C
T 26x15x13	50	120	26.0±0.6	15.0±0.5	13.0±0.5
T 28x7.5x16	30	80	28.0±0.7	7.50±0.4	16.0±0.6
T 28x8x18	25	75	28.0±0.7	8.00±0.4	18.0±0.6
T 28x10x16	35	90	28.0±0.7	10.0±0.4	16.0±0.6
T 28x10x18	30	85	28.0±0.7	10.0±0.4	18.0±0.6
T 28x13x16	45	105	28.0±0.7	13.0±0.5	16.0±0.6
T 28x20x16	50	135	28.0±0.7	20.0±0.5	16.0±0.6
T 28x28x16	85	200	28.0±0.7	28.0±0.7	16.0±0.6
T 28.5x28.5x13.8	120	250	28.5±0.7	28.5±0.7	13.8±0.5
T 29x7.7x19	25	75	29.0±1.0	7.70±0.4	19.0±0.6
T 29x10x19	30	85	29.0±1.0	10.0±0.4	19.0±0.6
T 29x12x19	35	90	29.0±1.0	12.0±0.5	19.0±0.6
T 29x13.8x19	45	95	29.0±1.0	13.8±0.5	19.0±0.6
T 29x15x19	35	100	29.0±1.0	15.0±0.5	19.0±0.6
T 31x5x19	20	70	31.0±1.0	5.00±0.4	19.0±0.6
T 31x7x19	25	75	31.0±1.0	7.00±0.4	19.0±0.6
T 31x8x19	25	80	31.0±1.0	8.00±0.4	19.0±0.6
T 31x10x19	35	90	31.0±1.0	10.0±0.4	19.0±0.6
T 31x12x18	35	105	31.0±1.0	12.0±0.5	18.0±0.6
T 31x12x21	30	85	31.0±1.0	12.0±0.5	21.0±0.6
T 31x13x19	40	100	31.0±1.0	13.0±0.5	19.0±0.6
T 31x16x19	45	115	31.0±1.0	16.0±0.5	19.0±0.6
T 31x18x19	50	125	31.0±1.0	18.0±0.5	19.0±0.6
T 35x6x20.8	30	75	35.0±1.0	6.00±0.5	20.8±0.6
T 35x12.6x20.8	50	100	35.0±1.0	12.6±0.5	20.8±0.6
T 36x10x20	30	70	36.0±1.0	10.0±0.4	20.0±0.6
T 36x12x25	30	80	36.0±1.0	12.0±0.5	25.0±0.6
T 36x12.7x25	32	85	36.0±1.0	12.7±0.5	25.0±0.6
T 36x13x23	35	95	36.0±1.0	13.0±0.5	23.0±0.6
T 36x20x23	50	115	36.0±1.0	20.0±0.6	23.0±0.6
T 36x23x15	100	210	36.0±1.0	23.0±0.6	15.0±0.6
T 40.6x15x27.4	40	90	40.6±1.5	15.0±0.5	27.4±0.6

\* All the data listed in this catalogue are for reference only, JENG SHI reserves the right to alter or revise the specifications without prior notification.

\* Beyond the above specification also can meet the special requirements. Need detailed content Please to the website query or contact us.